

Note: The limits, including the height and depths of the Works, shown in this drawing are not to be taken as limiting the obligations of the contractor under Contract.

1. DO NOT SCALE FROM THIS DRAWING

SAFETY, HEALTH AND ENVIRONMENTAL INFORMATION

IN ADDITION TO THE HAZARDS OR RISKS NORMALLY ASSOCIATED WITH THE TYPES OF WORK DETAILED ON THIS DRAWING, THE FOLLOWING SIGNIFICANT RESIDUAL RISKS SHOULD BE NOTED. FURTHER DETAILS ARE INCLUDED IN THE CDM DESIGN RISK MANAGEMENT REGISTER

CONSTRUCTION:

S.1 Archaeological impacts  
Implement mitigation measures entailing appropriate recording actions through further archaeological works

MAINTENANCE, CLEANING AND OPERATION:

NO SIGNIFICANT RISKS IDENTIFIED

DECOMMISSIONING OR DEMOLITION:

NO SIGNIFICANT RISKS IDENTIFIED

NOT FOR CONSTRUCTION

Rev	Drawn	Chkd	Revised	Approved	Date	Description

Designed by: \_\_\_\_\_ Date: \_\_\_\_\_

Status: \_\_\_\_\_

Client: \_\_\_\_\_



Client Drawing No. \_\_\_\_\_ Revision \_\_\_\_\_



Black & Veatch Limited  
60 High Street, Farnham, Surrey, GU11 1SA, United Kingdom  
Tel: +44(0)1737 774155

Project: Mote Park Lake Reservoir Engineering Services

Options Appraisal Report

Drawing title: Spillway Option C+A

Sheet 1

Drawing scale: NTS Sheet size: A1

122775-BVL-Z0-00-SK-Z-00001 P01

**Spillway Option C**

Spillway formed with:  
Reinforced Concrete Steps or  
Articulated Concrete Blocks (covered with grass)

Spillway width: 58m

Spillway gradient: 1 in 4

Spillway crest: 21.8m OD

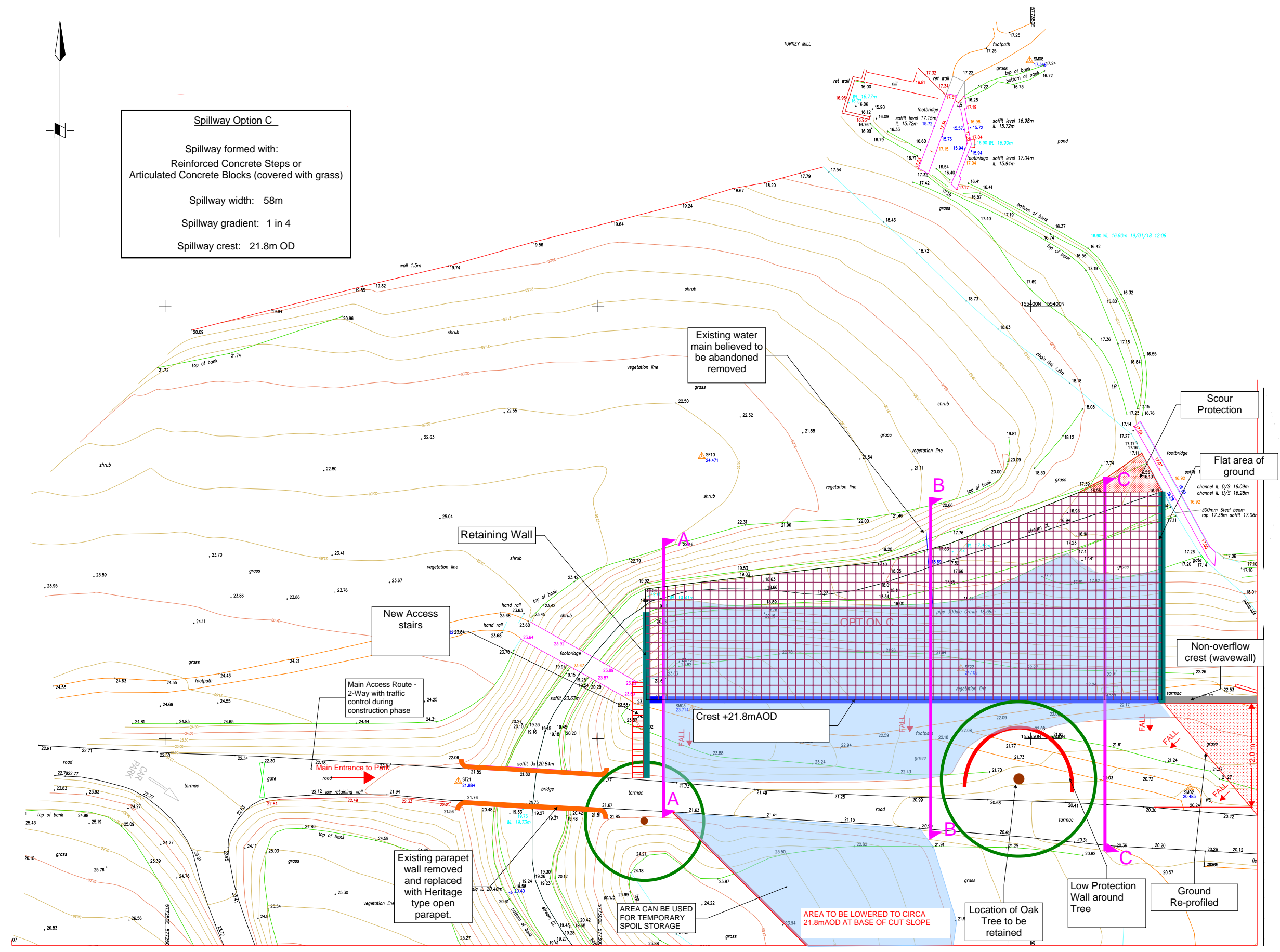

Note: The limits, including the height and depths of the Works, shown in this drawing are not to be taken as limiting the obligations of the contractor under Contract.

1. DO NOT SCALE FROM THIS DRAWING

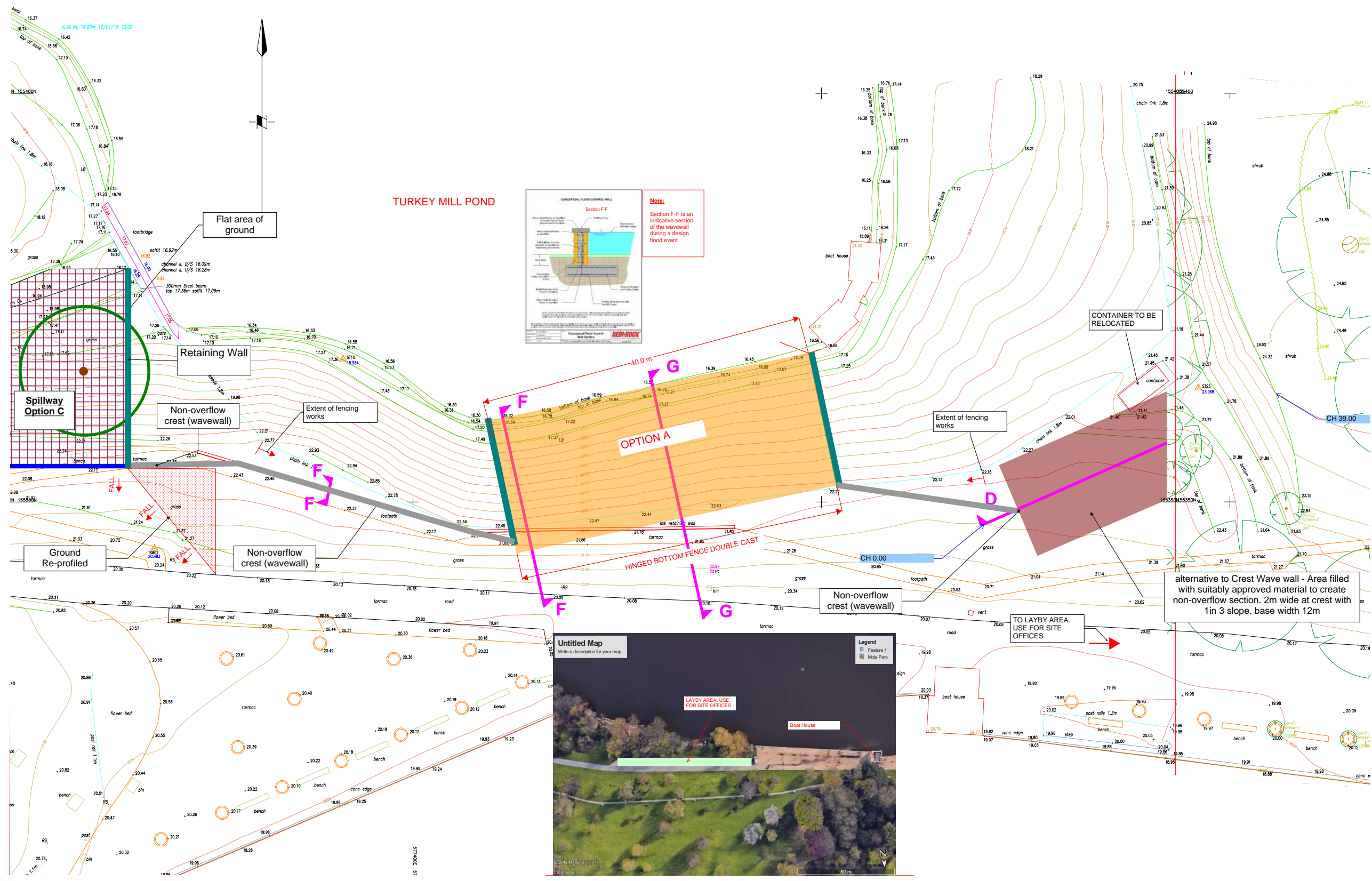

**SAFETY, HEALTH AND ENVIRONMENTAL INFORMATION**

IN ADDITION TO THE HAZARDS OR RISKS NORMALLY ASSOCIATED WITH THE TYPES OF WORK DETAILED ON THIS DRAWING, THE FOLLOWING SIGNIFICANT RESIDUAL RISKS SHOULD BE NOTED. FURTHER DETAILS ARE INCLUDED IN THE CDM DESIGN RISK MANAGEMENT REGISTER

**CONSTRUCTION:**

**S.1 Archaeological impacts**  
 Implement mitigation measures entailing appropriate recording actions through further archaeological works

**MAINTENANCE, CLEANING AND OPERATION:**

**NO SIGNIFICANT RISKS IDENTIFIED**

**DECOMMISSIONING OR DEMOLITION:**

**NO SIGNIFICANT RISKS IDENTIFIED**

**NOT FOR CONSTRUCTION**

Rev	Drawn	Chkd	Revised	Approved	Date	Description

Designed by: \_\_\_\_\_ Date: \_\_\_\_\_  
 Status: \_\_\_\_\_



Client Drawing No. \_\_\_\_\_ Revision \_\_\_\_\_



Project: **Mote Park Lake Reservoir Engineering Services**  
**Options Appraisal Report**

Drawing title: **Spillway Option C+A**  
**Sheet 2**

Drawing scale: **NTS** Sheet size: **A1**  
**122775-BVL-Z0-00-SK-Z-00002** Revision: **P01**



OPTION C

RES C L 1.85 ASD  
 B - 94 AC  
 2.86

HO - ST

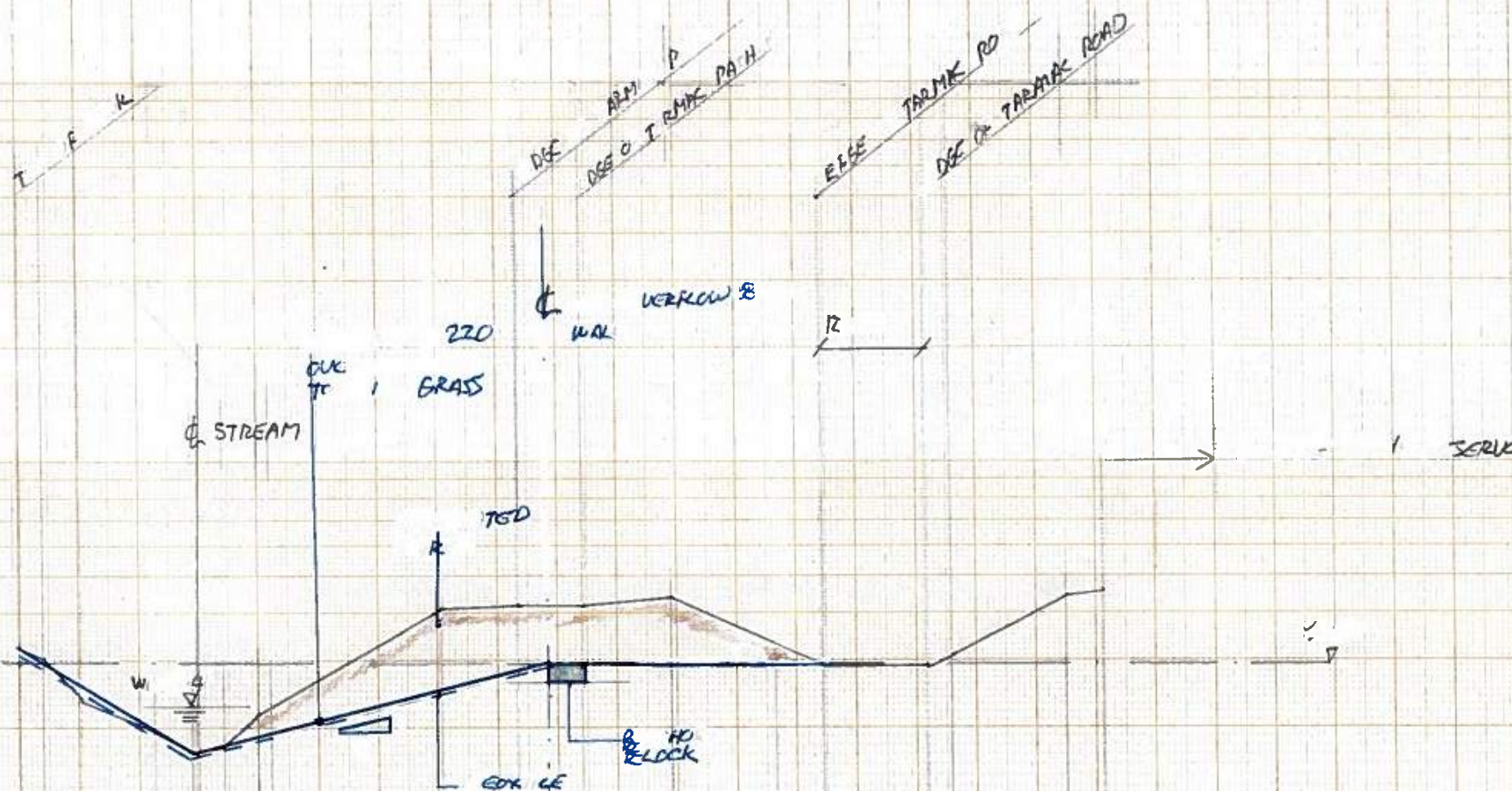

Station	Height
22.46	0.00
22.50	0.50
22.52	0.52
19.60	4.50
18.94	5.70
19.16	6.00
20.68	8.00
23.63	1.10
2.67	1.00
17.50	
2.67	1.80
24.00	2.80
21.73	2.80
21.70	3.00
22.00	3.00
24.00	3.80
24.76	3.50

G - T A A

KE RES R E NG

Note: The limits, including the height and depths of the Works, shown in this drawing are not to be taken as limiting the obligations of the contractor under Contract.

1. DO NOT SCALE FROM THIS DRAWING

SAFETY, HEALTH AND ENVIRONMENTAL INFORMATION

IN ADDITION TO THE HAZARDS OR RISKS NORMALLY ASSOCIATED WITH THE TYPES OF WORK DETAILED ON THIS DRAWING, THE FOLLOWING SIGNIFICANT RESIDUAL RISKS SHOULD BE NOTED. FURTHER DETAILS ARE INCLUDED IN THE CDM DESIGN RISK MANAGEMENT REGISTER

CONSTRUCTION:

S.1 Archaeological impacts  
 Implement mitigation measures entailing appropriate recording actions through further archaeological works

MAINTENANCE, CLEANING AND OPERATION:

NO SIGNIFICANT RISKS IDENTIFIED

DECOMMISSIONING OR DEMOLITION:

NO SIGNIFICANT RISKS IDENTIFIED

NOT FOR CONSTRUCTION

Rev	Drawn	Chkd	Rvld	Appvd	Date	Description

Designed by: \_\_\_\_\_ Date: \_\_\_\_\_  
 Status: \_\_\_\_\_

Client: \_\_\_\_\_



Client Drawing No. \_\_\_\_\_ Revision \_\_\_\_\_



Black & Veatch Limited  
 60 High Street, Farnham, Surrey, GU11 1SU, United Kingdom  
 Tel: +44(0)1737 774155

Project: Mote Park Lake Reservoir Engineering Services  
 Options Appraisal Report

Drawing title: Spillway Option C+A  
 Sheet 3

Drawing scale: NTS Sheet size: A1

122775-BVL-Z0-00-SK-Z-00003 Revision P01



Note: The limits, including the height and depths of the Works, shown in this drawing are not to be taken as limiting the obligations of the contractor under Contract.

1. DO NOT SCALE FROM THIS DRAWING

SAFETY, HEALTH AND ENVIRONMENTAL INFORMATION  
 IN ADDITION TO THE HAZARDS OR RISKS NORMALLY ASSOCIATED WITH THE TYPES OF WORK DETAILED ON THIS DRAWING, THE FOLLOWING SIGNIFICANT RESIDUAL RISKS SHOULD BE NOTED. FURTHER DETAILS ARE INCLUDED IN THE CDM DESIGN RISK MANAGEMENT REGISTER

CONSTRUCTION:  
**S.1 Archaeological impacts**  
 Implement mitigation measures entailing appropriate recording actions through further archaeological works

MAINTENANCE, CLEANING AND OPERATION:  
**NO SIGNIFICANT RISKS IDENTIFIED**

DECOMMISSIONING OR DEMOLITION:  
**NO SIGNIFICANT RISKS IDENTIFIED**

**NOT FOR CONSTRUCTION**

Rev	Drawn	Chkd	Rvwd	Appvd	Date	Description

Designed by: \_\_\_\_\_ Date: \_\_\_\_\_  
 Status: \_\_\_\_\_

Client: \_\_\_\_\_



Client Drawing No. \_\_\_\_\_ Revision \_\_\_\_\_



Black & Veatch Limited  
 60 High Street, Farnham, Surrey, GU11 1SU, United Kingdom  
 Tel: +44(0)1737 774155

Project: **Mote Park Lake Reservoir Engineering Services**  
**Options Appraisal Report**

Drawing title: **Spillway Option C+A**  
**Sheet 4**

Drawing scale: **NTS** Sheet size: **A1**  
 122775-BVL-Z0-00-SK-Z-00004 Revision **P01**

OPTION C

CREST LEVEL = 21.80 m AOD

BED LEVEL = 17.52 m AOD  
 4.28m

HORIZ. DIST  
 21.3 - 7.10 = 14.20m

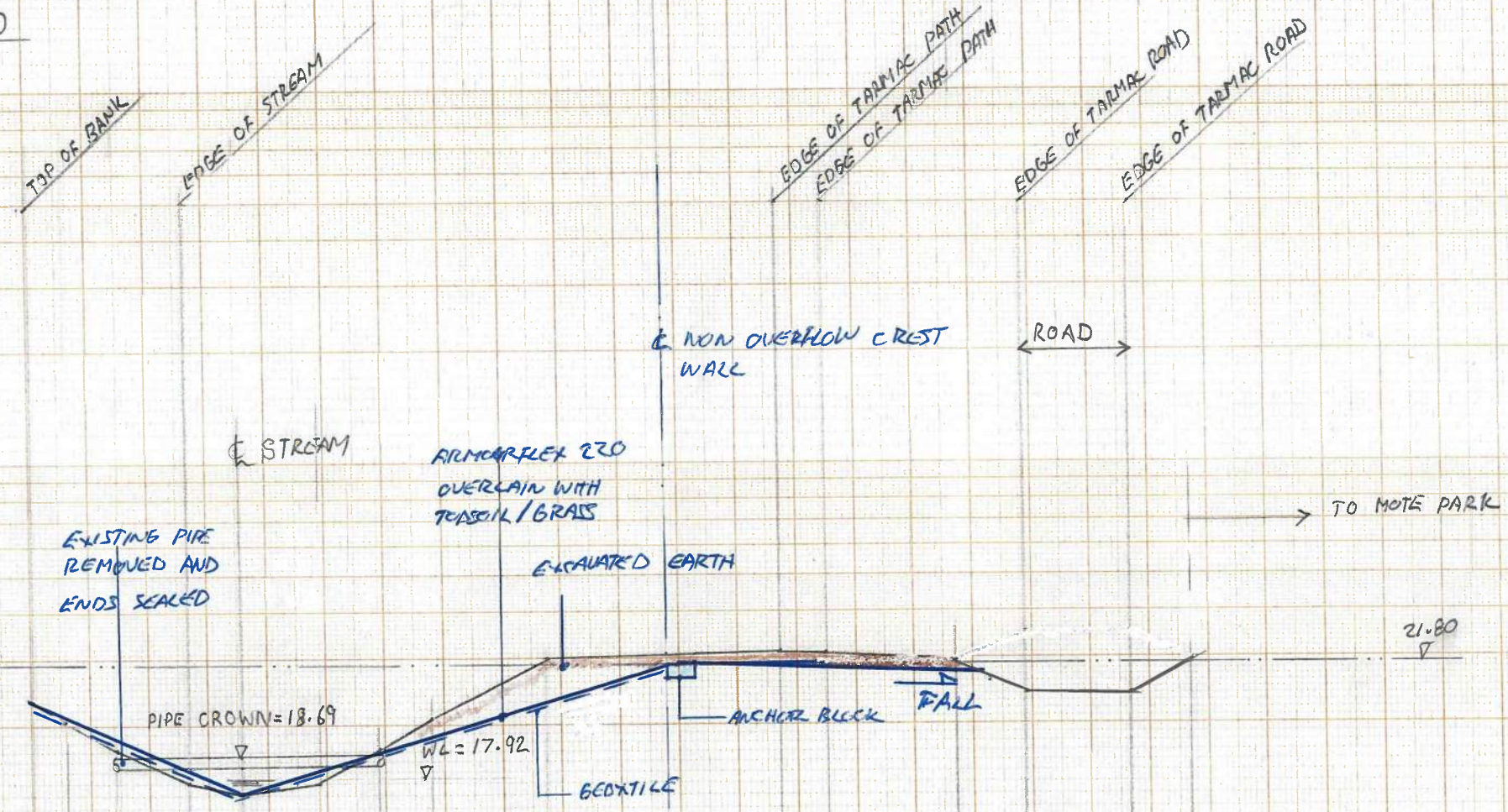

CHAINAGE (m)	GROUND LEVEL (m AOD)
20.66 0.00	20.00 1.20
19.00 2.80	17.90 5.20
17.52 7.10	17.90 9.70
19.00 11.70	20.00 13.50
22.00 17.40	21.80 21.30
22.18 25.30	22.18 26.90
22.00 31.30	20.80 33.00
20.80 37.20	21.90 39.20

SECTION B-B







Note: The limits, including the height and depths of the Works, shown in this drawing are not to be taken as limiting the obligations of the contractor under Contract.

1. DO NOT SCALE FROM THIS DRAWING

SAFETY, HEALTH AND ENVIRONMENTAL INFORMATION  
 IN ADDITION TO THE HAZARDS OR RISKS NORMALLY ASSOCIATED WITH THE TYPES OF WORK DETAILED ON THIS DRAWING, THE FOLLOWING SIGNIFICANT RESIDUAL RISKS SHOULD BE NOTED. FURTHER DETAILS ARE INCLUDED IN THE CDM DESIGN RISK MANAGEMENT REGISTER

CONSTRUCTION:  
**S.1 Archaeological impacts**  
 Implement mitigation measures entailing appropriate recording actions through further archaeological works

MAINTENANCE, CLEANING AND OPERATION :  
**NO SIGNIFICANT RISKS IDENTIFIED**

DECOMMISSIONING OR DEMOLITION :  
**NO SIGNIFICANT RISKS IDENTIFIED**

**NOT FOR CONSTRUCTION**

Rev	Drawn	Chkd	Rvwd	Appvd	Date	Description

Designed by: \_\_\_\_\_ Date: \_\_\_\_\_

Status: \_\_\_\_\_

Client: \_\_\_\_\_



Client Drawing No. \_\_\_\_\_ Revision \_\_\_\_\_



Black & Veatch Limited  
 60 High Street, Farnham, Surrey, GU11 1SU, United Kingdom  
 Tel: +44(0)1737 774155

Project: **Mote Park Lake Reservoir Engineering Services**  
**Options Appraisal Report**

Drawing title: **Spillway Option C Sheet 6**

Drawing scale: **NTS** Sheet size: **A1**

122775-BVL-Z0-00-SK-Z-00006 Revision **P01**

OPTION C

SCALE 1:200 VERT & HORIZ

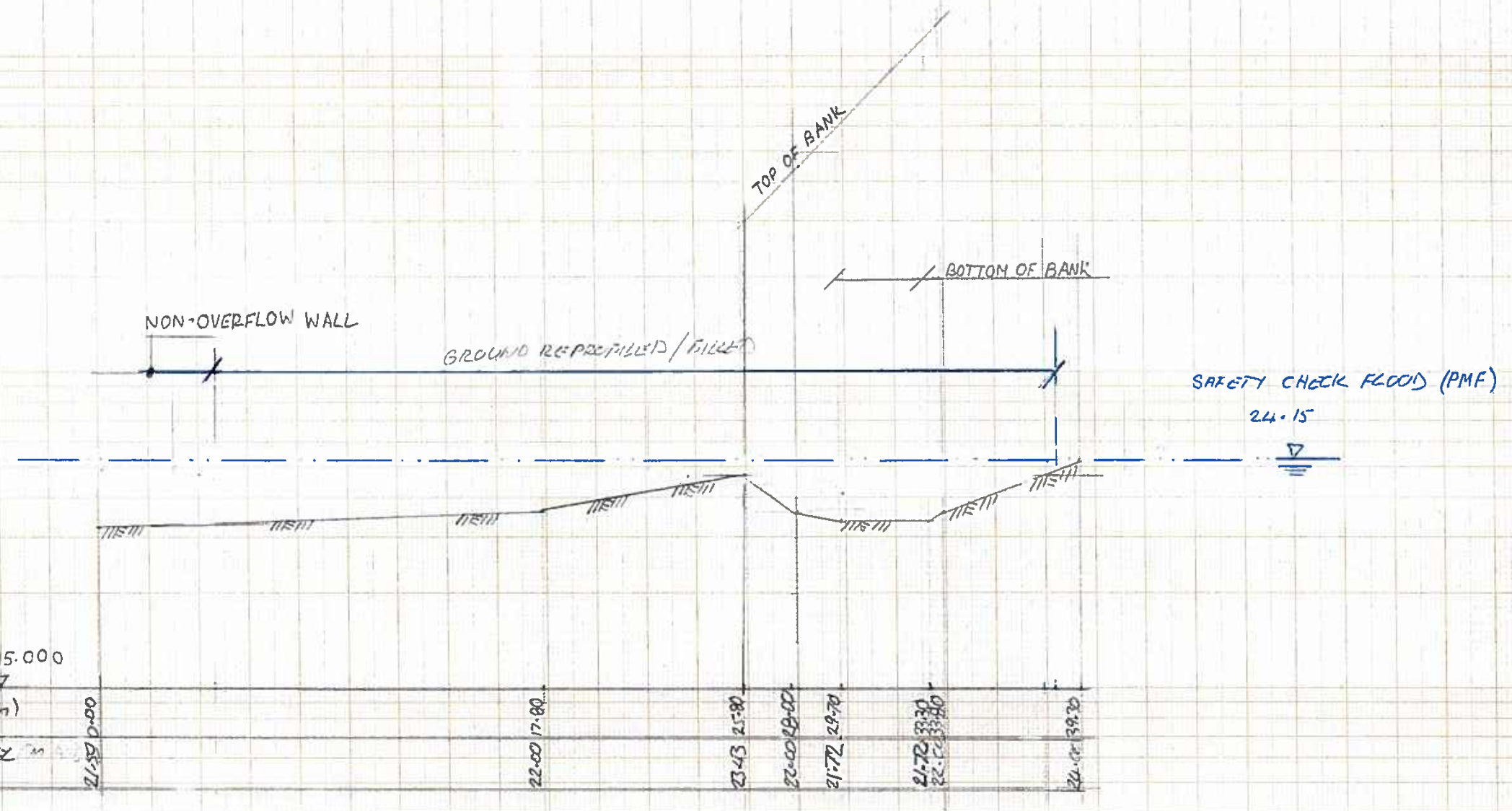

SECTION D-D

MOTE PARK LAKE RESERVOIR ENGINEERING SERVICES



OPTION C

SCALE 1:200 VERT & HORIZ

MOTE PARK LAKE  
←

LANDSCAPING AS-REQUIRED

SAFETY CHECK FLOOD (PMF)  
24-15

EXISTING GROUND LEVEL

CORE

DATUM = 15.00

CHAINAGE (m)

GROUND LEVEL (M.A.D.)

0.00

1.90

14.00

19.80

SECTION E-E

MOTE PARK LAKE RESERVOIR ENGINEERING SERVICES

Note: The limits, including the height and depths of the Works, shown in this drawing are not to be taken as limiting the obligations of the contractor under Contract.

1. DO NOT SCALE FROM THIS DRAWING

SAFETY, HEALTH AND ENVIRONMENTAL INFORMATION

IN ADDITION TO THE HAZARDS OR RISKS NORMALLY ASSOCIATED WITH THE TYPES OF WORK DETAILED ON THIS DRAWING, THE FOLLOWING SIGNIFICANT RESIDUAL RISKS SHOULD BE NOTED. FURTHER DETAILS ARE INCLUDED IN THE CDM DESIGN RISK MANAGEMENT REGISTER

CONSTRUCTION:

S.1 Archaeological impacts  
Implement mitigation measures entailing appropriate recording actions through further archaeological works

MAINTENANCE, CLEANING AND OPERATION:

NO SIGNIFICANT RISKS IDENTIFIED

DECOMMISSIONING OR DEMOLITION:

NO SIGNIFICANT RISKS IDENTIFIED

NOT FOR CONSTRUCTION

Rev	Drawn	Chkd	Rvwd	Appvd	Date	Description
-----	-------	------	------	-------	------	-------------

Designed by: \_\_\_\_\_ Date: \_\_\_\_\_

Status: \_\_\_\_\_

Client: \_\_\_\_\_



Client Drawing No. \_\_\_\_\_ Revision \_\_\_\_\_



Black & Veatch Limited  
60 High Street, Farnham, Surrey, GU11 1SA, United Kingdom  
Tel: +44(0)1737 774155

Project: Mote Park Lake Reservoir Engineering Services

Drawing title: Options Appraisal Report

Spillway Option C+A  
Sheet 7

Drawing scale: NTS Sheet size: A1

122775-BVL-Z0-00-SK-Z-00007 Revision P01



OPTION A+C

SCALE 1:100 VERT & HORIZ

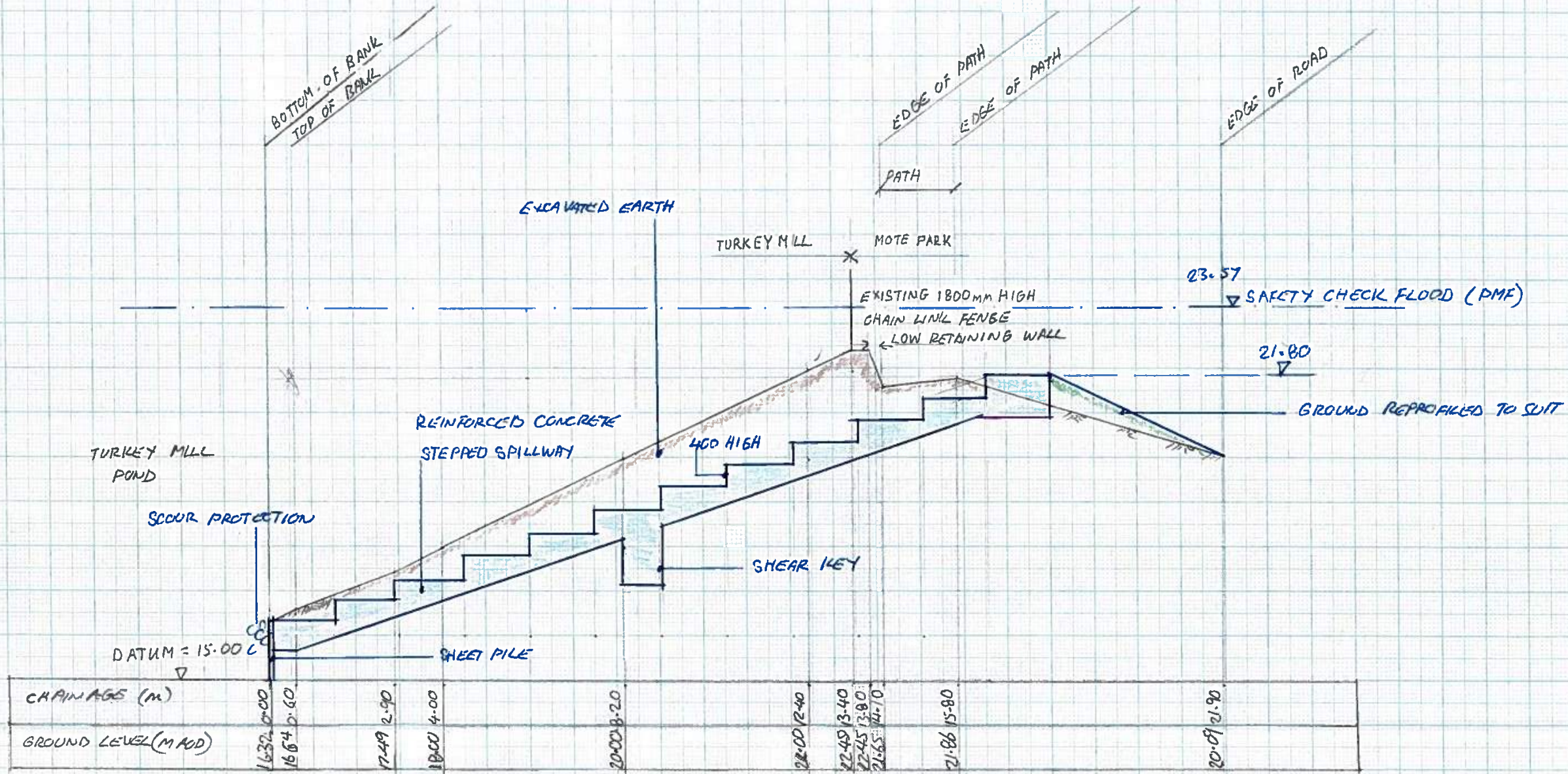

SECTION FF

MOTE PARK LAKE RESERVOIR ENGINEERING SERVICES

Note: The limits, including the height and depths of the Works, shown in this drawing are not to be taken as limiting the obligations of the contractor under Contract.

1. DO NOT SCALE FROM THIS DRAWING

SAFETY, HEALTH AND ENVIRONMENTAL INFORMATION

IN ADDITION TO THE HAZARDS OR RISKS NORMALLY ASSOCIATED WITH THE TYPES OF WORK DETAILED ON THIS DRAWING, THE FOLLOWING SIGNIFICANT RESIDUAL RISKS SHOULD BE NOTED. FURTHER DETAILS ARE INCLUDED IN THE CDM DESIGN RISK MANAGEMENT REGISTER

CONSTRUCTION:

**S.1 Archaeological impacts**  
Implement mitigation measures entailing appropriate recording actions through further archaeological works

MAINTENANCE, CLEANING AND OPERATION:

NO SIGNIFICANT RISKS IDENTIFIED

DECOMMISSIONING OR DEMOLITION:

NO SIGNIFICANT RISKS IDENTIFIED

**NOT FOR CONSTRUCTION**

Rev	Drawn	Chkd	Revd	Appvd	Date	Description

Designed by: \_\_\_\_\_ Date: \_\_\_\_\_

Status: \_\_\_\_\_

Client: \_\_\_\_\_



Client Drawing No. \_\_\_\_\_ Revision \_\_\_\_\_



Black & Veatch Limited  
60 High Street, Farnham, Surrey, GU11 1SA, United Kingdom  
Tel: +44(0)1737 774155

Project: **Mote Park Lake Reservoir Engineering Services**

**Options Appraisal Report**

Drawing title: **Spillway Option C+A**

**Sheet 8**

Drawing scale: **NTS** Sheet size: **A1**

122775-BVL-Z0-00-SK-Z-00008 Revision **P01**



OPTION A+C

SCALE 1:100 VERT & HORIZ

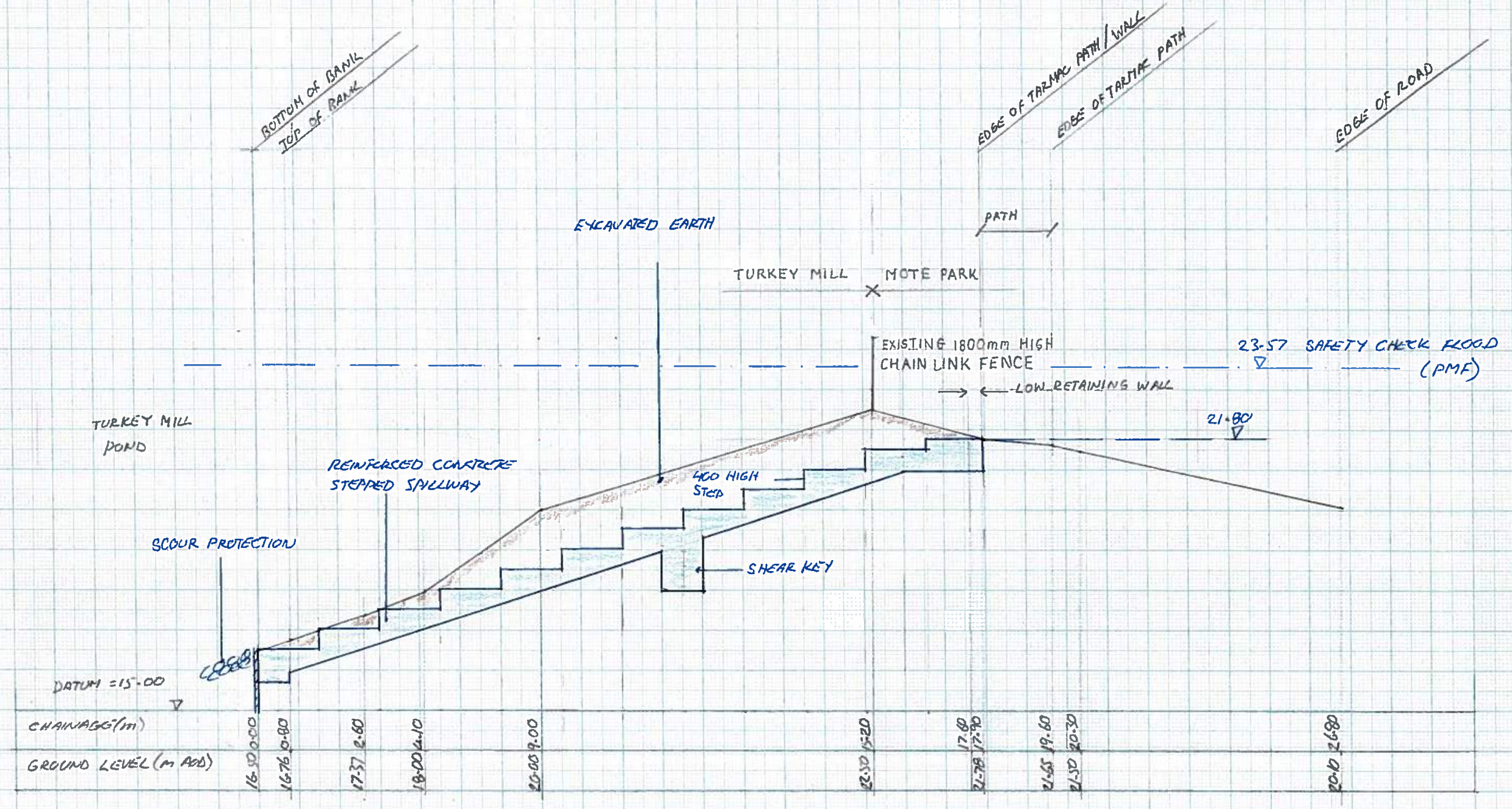

SECTION 6-6

MOTE PARK LAKE RESERVOIR ENGINEERING SERVICES

Note: The limits, including the height and depths of the Works, shown in this drawing are not to be taken as limiting the obligations of the contractor under Contract.

1. DO NOT SCALE FROM THIS DRAWING

SAFETY, HEALTH AND ENVIRONMENTAL INFORMATION  
 IN ADDITION TO THE HAZARDS OR RISKS NORMALLY ASSOCIATED WITH THE TYPES OF WORK DETAILED ON THIS DRAWING, THE FOLLOWING SIGNIFICANT RESIDUAL RISKS SHOULD BE NOTED. FURTHER DETAILS ARE INCLUDED IN THE CDM DESIGN RISK MANAGEMENT REGISTER

CONSTRUCTION:  
**S.1 Archaeological impacts**  
 Implement mitigation measures entailing appropriate recording actions through further archaeological works

MAINTENANCE, CLEANING AND OPERATION:  
**NO SIGNIFICANT RISKS IDENTIFIED**

DECOMMISSIONING OR DEMOLITION:  
**NO SIGNIFICANT RISKS IDENTIFIED**

**NOT FOR CONSTRUCTION**

Rev	Drawn	Chkd	Revd	Appvd	Date	Description

Designed by: \_\_\_\_\_ Date: \_\_\_\_\_  
 Status: \_\_\_\_\_



Client Drawing No. \_\_\_\_\_ Revision \_\_\_\_\_



Project: **Mote Park Lake Reservoir Engineering Services**  
 Options Appraisal Report

Drawing title: **Spillway Option C+A**  
**Sheet 9**

Drawing scale: **NTS** Sheet size: **A1**  
 122775-BVL-Z0-00-SK-Z-00009 Revision **P01**